

# Quadloc® Model 4422 Comparison Sheet

## THE MORE COMPACT QUADLOC® MODEL 4422

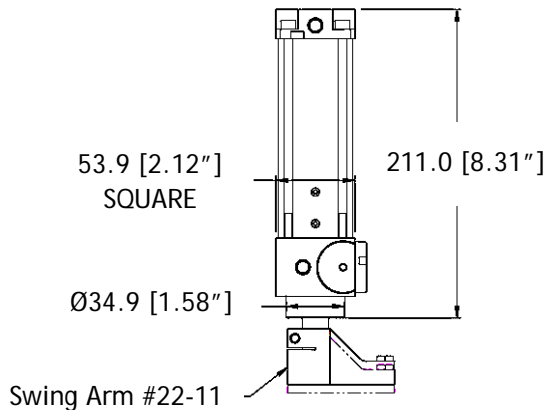

## LEADING COMPARABLE COMPETITOR

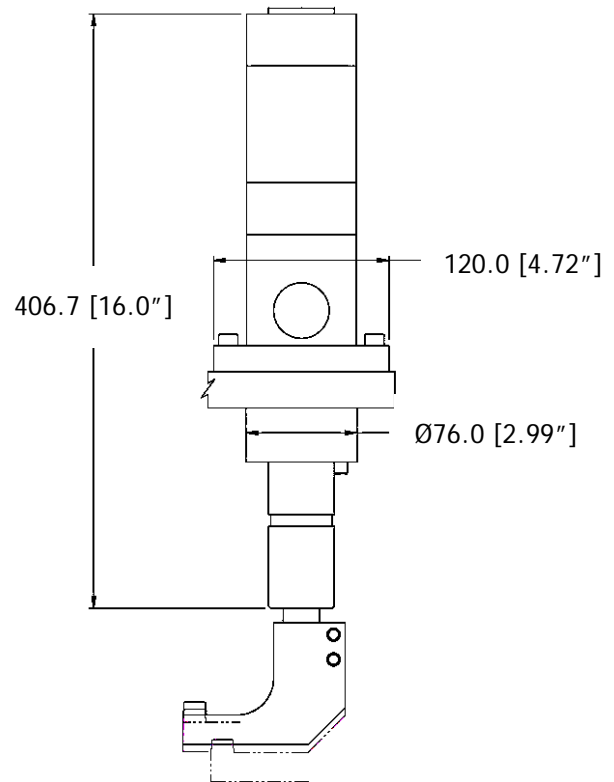

- |   |  |
|---|--|
| <ul style="list-style-type: none"> <li>• No design time necessary because it's an all-in-one locking swing arm clamp</li> <li>• Stays locked through loss of power</li> <li>• Only one accessory (Swing Arm #22-11) needed</li> <li>• 250lbs of clamp force at 60psi</li> <li>• 500lbs of holding force regardless of clamping force, with or without air</li> <li>• Independent rotate that requires no extra clearance</li> <li>• Swing stroke - None</li> <li>• Clamping stroke - 5.8mm</li> <li>• Total Weight - 4.9lbs</li> <li>• Total price - \$2,387 / EA.</li> </ul> | <ul style="list-style-type: none"> <li>• Significant design time required to create a locking swing arm clamp</li> <li>• Requires multiple components (Cylinder, Rod Locks, Cam Rotating Shaft Assembly, Adapters, Couplers, Swing Arm, etc..) to create a locking swing arm cylinder</li> <li>• 260lbs of clamping force at 60psi</li> <li>• Holding force of 450lbs with loss of air only</li> <li>• Extra clearance required due to its cam slot rotate</li> <li>• Swing stroke - 25mm</li> <li>• Clamping stroke - 5.0mm</li> <li>• Total Weight - 26.5lbs</li> <li>• Total price - \$4,240 / EA.</li> </ul> |
|---|--|